



**ASDAN Functional Mathematics
January 2009**

**Level 1
Test Paper 2**

Candidate Question Paper

Centre Name:	Centre Number:
Candidate Name:	Candidate Number:
Date completed:	

Instructions to Candidates

- You have 30 minutes to complete this paper.
- Write all your answers on the paper.
- You may use a pen, pencil, eraser, ruler, mathematical drawing equipment and a calculator.
- Marks will be given for working.

ASDAN USE ONLY

Task number	Paper 2 – marks	
	Total marks	Candidate marks
1	10	
2	10	
TOTAL MARKS	20	



THIS IS A BLANK PAGE



Functional Mathematics Level 1

There are 2 parts to this assessment:

Paper 1 - A problem solving task (Total 40 marks)

Paper 2 - Short questions to be answered on the paper (Total 20 marks)

Both papers will be carried out under controlled conditions.

You must complete both parts of the assessment to gain your Functional Mathematics qualification at Level 1.

You have 1 hour to complete Paper 1 and 30 minutes to complete Paper 2.

Task 1 Personal Finance

1: Sam has a current account at a local bank. The table below shows some of his recent spending and paying in:

Date	Transaction
12 th November	Opening balance: £43.50
13 th November	Paid in: £45
15 th November	Paid out by cheque: £79.99 for a new jacket
24 th November	Taken out: £50 in cash
30 th November	Paid in: £65

a) Calculate how much money is in Sam's account after each transaction.

12th November:

(Opening balance)

.....

13th November:

.....

15th November:

.....

24th November:

.....

30th November:

.....

(2 marks)

b) Show how you would check that your final amount is correct.

Checking:

(1 mark)



2: Sam buys a TV costing £380. He buys it on hire purchase for 2 years. The rate of interest for the hire purchase is 28% per year. The charge for the interest is given by the formula below.

$$\text{Interest charged} = \frac{\text{cost of TV} \times \text{rate of interest per year}(\%) \times \text{number of years}}{100}$$

Working

a) How much interest is charged?

Answer..... (2 marks)

Working

b) How much will he have to pay back altogether?

Answer..... (2 marks)

Working

c) How does he pay back each month?

Answer.....

Check that this is correct.

Checking

(3 marks)

(Total: 10 marks)

End of Task 1.

Task 2

Floor covering for a new flat

You have moved into a new flat and want to put some wood flooring in the living room. The builder has given you the plan for the flat with the scale for the drawing.

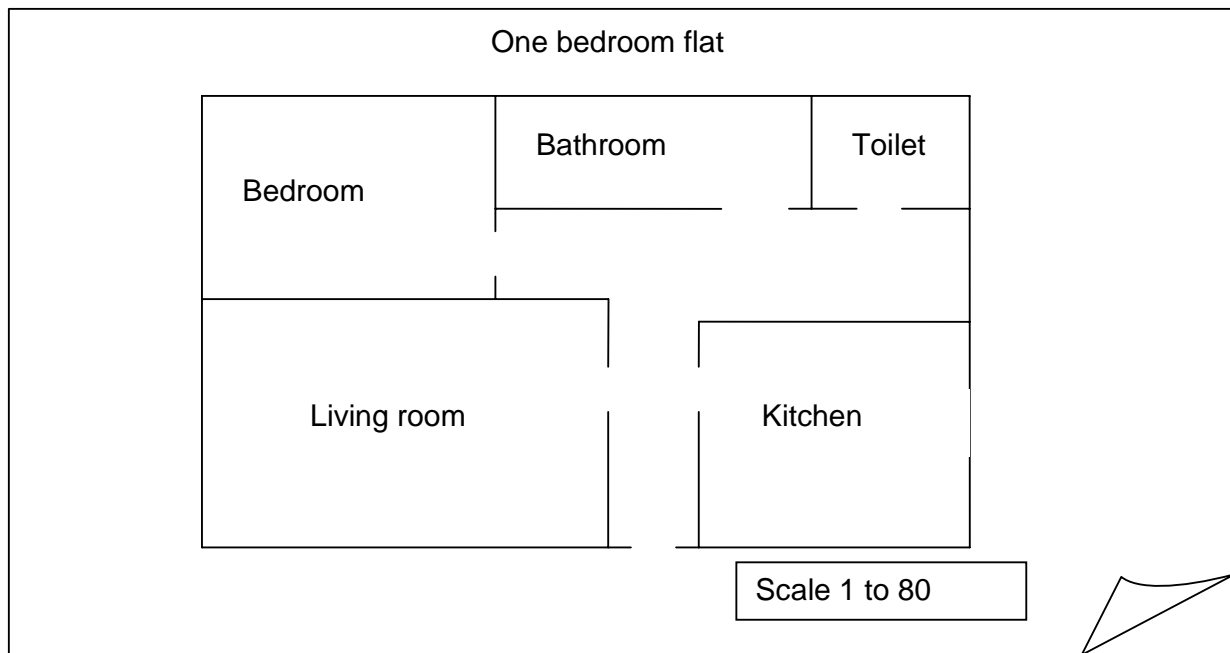

On the plan, the measurements for the living room are 5cm by 6cm.

Working

a) What are the actual measurements of the room in metres?

Answer..... (3 marks)



Working

b) What is the area of the room?

Answer..... (2 marks)

The flooring is sold in packs which each cover an area of 1.67m^2 .

Working

c) How many packs will you need to cover the floor?

Answer..... (3 marks)

Each pack costs £54.52.

Working

d) What will the total cost of the flooring be?

Answer..... (2 marks)

(Total: 10 marks)

End of Task 2.



THIS IS A BLANK PAGE